



Copyright FCI

1 | 2



FCIconnect.com



3 |



4

PRODUCT NUMBER  
SEE SHEET 2

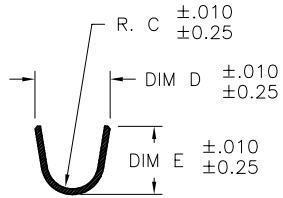

SECTION J-J  
SCALE 8:1

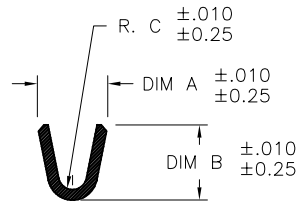

SECTION H-H  
SCALE 8:1

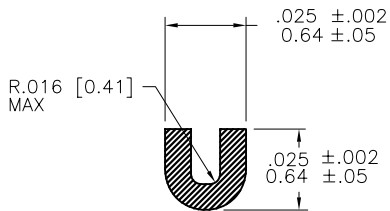

SECTION G-G  
SCALE 5:1

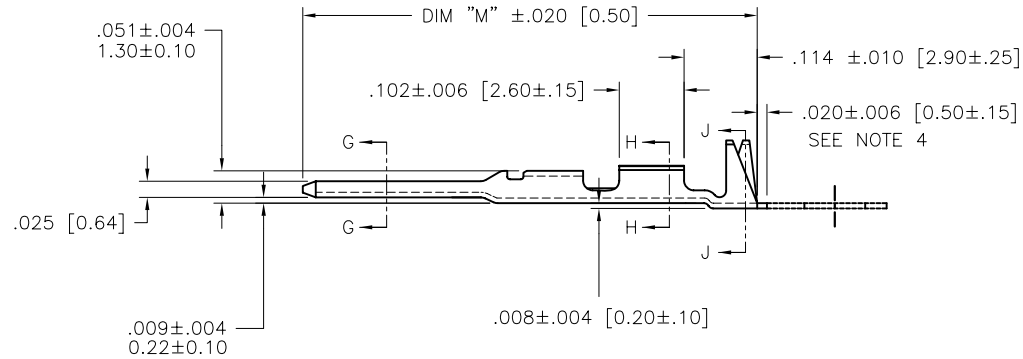
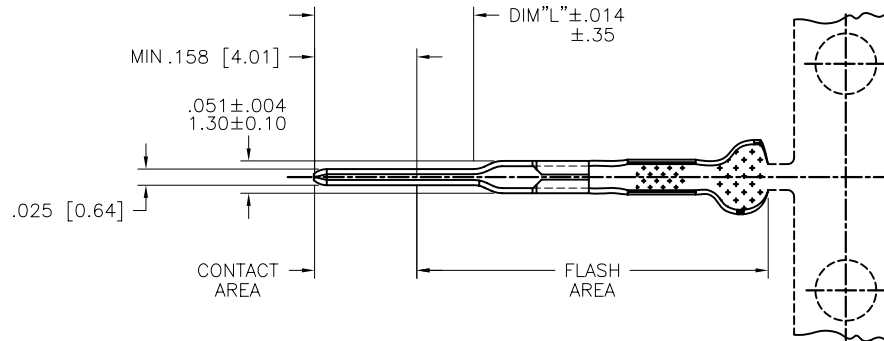

mat'l. code SEE NOTE 5				surface <input checked="" type="checkbox"/> tolerance		projection	product family PV TERMINALS	
ltr	ecn no	dr	date	tolerances unless otherwise specified			title	
K	V41705	SAR	1994-12-09	angles	XX +.01/X+.3		INCH/MM	C.T.W. MALE PIN
L	V71294	HTB	1997-09-22		XXX +.005/XXX+.13	scale 4:1		sheet 1 of 2 size
M	V05-0209	HTB	2005-03-01	0° ±2'	XXXX +.0020/XXX+.051			75967 A4
N	V05-0467	HTB	2005-05-23	dr	S. ROYER	sheet 1 of 2 size		
P	V05-0530	HTB	2005-05-31	engr	T. HANNA	75967 A4		
R	V06-0624	HTB	2006-06-30	chr	T. HANNA	sheet 1 of 2 size		
S	V08-0114	HTB	2008-04-01	appd	T. HANNA	75967 A4		
sheet	revision	S	S			type		CUSTOMER Drawing
index	sheet	1	2					

form: A4mmXLC

1

2

3

4



PRODUCT NUMBER	AWG	WIRE BARREL			INSULATION BARREL				DIM "L"	DIM "M"
		DIM "A"	DIM "B"	DIM "C"	DIM "D"	DIM "E"	DIM "F"			
75967-XY1		O B S O L E T E								
75967-XY1LF	28-32	.054/1.37	.058/1.47	.011/0.28	.115/2.92	.105/2.67	.040/1.02	.253/6.42	.697/17.70	
75967-XY2		O B S O L E T E								
75967-XY2LF	22-26	.070/1.78	.070/1.78	.017/0.43	.139/3.53	.120/3.05	.050/1.27	.253/6.42	.697/17.70	
75967-XY3		O B S O L E T E								
75967-XY3LF	18-20	.104/2.64	.104/2.64	.021/0.53	.139/3.53	.120/3.05	.050/1.27	.253/6.42	.697/17.70	
75967-XY7		U N A V A I L A B L E								
75967-XY8		U N A V A I L A B L E								
75967-XY9		U N A V A I L A B L E								

PRODUCT NUMBER

75967-XYZLF

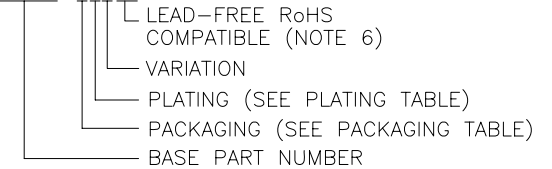

PLATING CODE	PLATING
75967-X1ZLF	30μ"/0.76μ Au IN CONTACT AREA; REMAINDER 3μ"/0.076μ Au FLASH OVER 50μ"/1.27μ Ni
75967-X2ZLF	15μ"/0.38μ Au IN CONTACT AREA; REMAINDER 3μ"/0.076μ Au FLASH OVER 50μ"/1.27μ Ni
75967-X3ZLF	50μ"/1.27μ Au IN CONTACT AREA; REMAINDER 3μ"/0.076μ Au FLASH OVER 50μ"/1.27μ Ni
75967-X6Z	O B S O L E T E
75967-X6ZLF	PRE-PLATED 100μ"/2.54μ TO 160μ"/4.06μ Sn (NOTE 8)
75967-X9ZLF	50μ"/1.27μ Au IN CONTACT AREA; REMAINDER 30μ"/0.76μ Au OVER 50μ"/1.27μ Ni

NOTES:

1. APPLICABLE SPECIFICATIONS  
BUS-12-098 PRODUCT SPECIFICATION
2. FOR PLATING SPECIFICATIONS SEE SHEET 2
3. FOR APPLICATION WITH MINI-LATCH HOUSING SEE TA-211
- ④ CUT-OFF DIMENSION FOR LOOSE PIECE VERSIONS
- ⑤ MATERIAL: BRASS ASTM B36 ALLOY C26000-H03
- ⑥ PRODUCT MEETS EUROPEAN UNION DIRECTIVES AND OTHER COUNTRY REGULATIONS AS DESCRIBED IN GS-22-008.
7. THIS PRODUCT IS NOT INTENDED TO BE EXPOSED TO MANUFACTURING SOLDER PROCESSES.
- ⑧ THIS PRODUCT HAS 100% TIN PLATING IN THE INTERFACE AND HAS NOT BEEN TESTED FOR WHISKER GROWTH IN ALL INTERCONNECT ENVIRONMENTS.

PACKAGING CODE	FINAL REELING	QUANTITY	APPLICATION INFORMATION
75967-OYZLF	LOOSE PIECE	1000 PER BOX	HANDTOOL
75967-1YZLF	RIGHT TO LEFT	8000 PER REEL	APPLICATOR R. TO L. FEEDING
75967-3YZLF	LEFT TO RIGHT	8000 PER REEL	APPLICATOR L. TO R. FEEDING
75967-4YZLF	LEFT TO RIGHT	250 PER REEL	HANDTOOL SMALL REEL

mat'l. code SEE NOTE 5		surface <input checked="" type="checkbox"/> tolerance		projection		product family PV TERMINALS							
ltr	ecrn no	dr	date	tolerances unless otherwise specified		title C.T.W. MALE PIN							
s				angles	<table border="1"> <tr><td>XX</td><td>+01/X+3</td></tr> <tr><td>XXX</td><td>+005/XX+13</td></tr> <tr><td>0' ±2'</td><td>XXXX +0020/XXX+051</td></tr> </table>	XX	+01/X+3	XXX	+005/XX+13	0' ±2'	XXXX +0020/XXX+051	INCH/MM	
XX	+01/X+3												
XXX	+005/XX+13												
0' ±2'	XXXX +0020/XXX+051												
						scale 4:1							
		dr	S. ROYER	1994-12-19									
		enr	T. HANNA	1994-12-19									
		chr	T. HANNA	1994-12-19									
		appd	T. HANNA	1994-12-19									
sheet index	revision sheet					dwg no 75967							
						sheet 2 of 2 size A4							
						type CUSTOMER Drawing							